

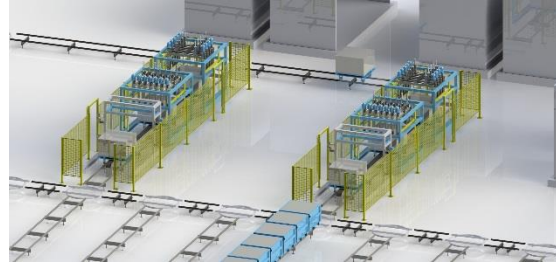

## TECHNICAL DATA SHEET

LithoPore® Cuttingmachine SM100

01/2015

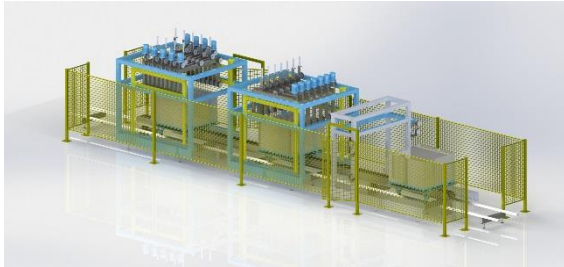

### Section 1: Product Specification

#### 1.1. Trade name

# LithoPore® Cuttingmachine SM100

#### 1.2. Manufacturer

Luca Industries International GmbH

Phone: +49 30 457989680

Fax: +49 30 457989689

Email: [info@luca-industries.com](mailto:info@luca-industries.com)

The **LithoPore® Cutting Machine SM100** is a dust free automatic wire cutting machine. It is suitable to cut wet foamed concrete LithoPore® up to ~200 kPa of compressive strength.

### Section 2: Advantages at a glance

- Dust free cutting process
- Reduced wastage material due to finer cutting wires
- Fast exchange of wires
- Flexible block design possible

### Section 3: Description

- Pre cutter for top and bottom cutting
- 2 x Main cutter for side cutting
- Fully-automatic cutting process
- Block height is fixed through mould height
- Flexible block dimension
- Minimum block thickness 75 mm
- Maximum internal mould dimensions (1220 x 1220 mm) (subject to adjustments)
- Maximum block height 700 mm (subject to adjustments)



TECHNICAL DATA SHEET

LithoPore® Cuttingmachine SM100

01/2015

Section 4: Technical Data

Powerage

Tower 1	1.00 kW
Tower 2	4.00 kW
Tower 3	5.00 kW
Driving Chain	1.50 kW
Air compressor	6.00 kW
Additional	1.50 kW
<b>In total</b>	<b>19.00 kW</b>
Voltage	400 V, 50 Hz
Current	47,5 A

Tower quantity: 1 x top and bottom cutter  
2 x side cutter

Cutting speed: subject to regulation through software  
Sample mould: included, 1set (1220x1220x700mm)  
Capacity, min: 8 cubic meters per hour  
Capacity, max: 12 cubic meters per hour  
Effective capacity: depends on numbers of vertical cuts  
Rail system: included  
Storing / operating temperature: +5°C to +60°C

Section 5: Application

The **LithoPore® Cutting Machine SM100** is only suitable for the cutting of wet foamed concrete LithoPore® up to ~200 kPa of compressive strength.

Section 6: Cutting Procedure

- The moulds have to be opened before cutting process begins
- The block is staying on the mould basement
- The block on mould basement will be placed on starting position.
- A chain will automatically bring the block to the first cutting position.
- Tower 1 for top and bottom cutting will drive automatically through the block.
- The block will be than transported automatically with the chain into Tower 2.
- The first vertical cut (longitudinal cutting) is done fully automatic (200mm or 150mm width)
- After the cut is finished the chain will bring the block automatically into Tower 3.
- The second vertical cut (transversal cutting) is done fully automatic (200mm or 150mm width)
- In case of need the tower can be automatically repositioned for 100mm or 75mm width
- The chain is pushing the block out of the cutting machine.
- Cut blocks have to be placed in further waiting area before final package
- 3 blocks can be cut simultaneously.

The information contained in this product specification is based on our current state of knowledge and experience. It does not free the user from making his own tests and trial applications. A legally binding assurance of certain properties cannot be inferred from this information. Any existing patent rights as well as any pertinent legal regulations must be observed by the recipient of our products under his own responsibility.

